

LBHK TYPE DUST SEALS (INSTALLED WITH INTERNAL GROOVE)

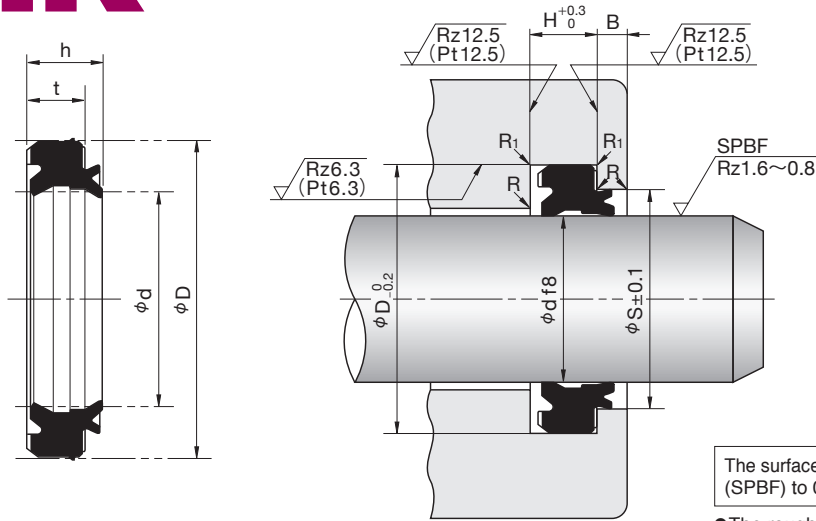

R = 0.3 or below
R₁ = 0.5 or below

The surface of the rod should be finished by buffing (SPBF) to 0.8 to 1.6μmRz (0.2 to 0.4μmRa).

● The roughness is JIS B 0601 : 2001.
When regulation length cannot be kept, apply Pt.

Nominal Size of Dust Seal, and Housing dimensions							NOK Part Number	
d	D	t	h	H	φS	B	Standard (A505)	Cold resistant (A567)
14	24	4.8	6.7	5	19	3	CL0533C0	CL0533C1
18	30	5.8	7.8	6	24		CL0534C0	CL0534C1
20	32				26		CL0535C0	CL0535C1
25	37				31		CL0536C0	CL0536C1
28	40				34		CL0537C0	CL0537C1
30	42				36		CL0531C1	CL0531C0
31.5	44	6.8	8.8	7	38		CL0538C0	CL0538C1
35	47				41		CL0527C0	CL0527C1
35.5	47.5				41.5		CL0539C0	CL0539C1
40	52				46		CL0540C0	CL0540C1
45	57				51		CL0541C0	CL0541C1
50	62				56		CL0542C0	CL0542C1
55	69				62		CL0543C0	CL0543C1
56	70				63		CL0544C0	CL0544C1
60	74	67	CL0518C1	CL0518C2				
63	77	70	CL0545C0	CL0545C1				
65	79	72	CL0546C0	CL0546C1				
70	84	77	CL0547C0	CL0547C1				
71	85	7.7	10	8	78	CL0548C0	CL0548C1	
75	89				82	CL0549C0	CL0549C1	
80	94				87	CL0519C1	CL0519C2	
85	99				92	CL0550C0	CL0550C1	
90	104				97	CL0551C0	CL0551C1	
95	109				102	CL0552C0	CL0552C1	
100	114				107	CL0553C0	CL0553C1	
105	121				8.7	11.4	9	113
106	120	7.7	10	8	113	3	CL0555C0	CL0555C1
110	126	8.7	11.4	9	118	4	CL0556C0	CL0556C1
112	128				120		CL0557C0	CL0557C1
115	131				123		CL0558C0	CL0558C1
118	134				126		CL0559C0	CL0559C1
120	136				128		CL0560C0	CL0560C1

E
DIMENSION
LBHK