

RYT TYPE

**WEAR RING
RAREFLON (PTFE)**

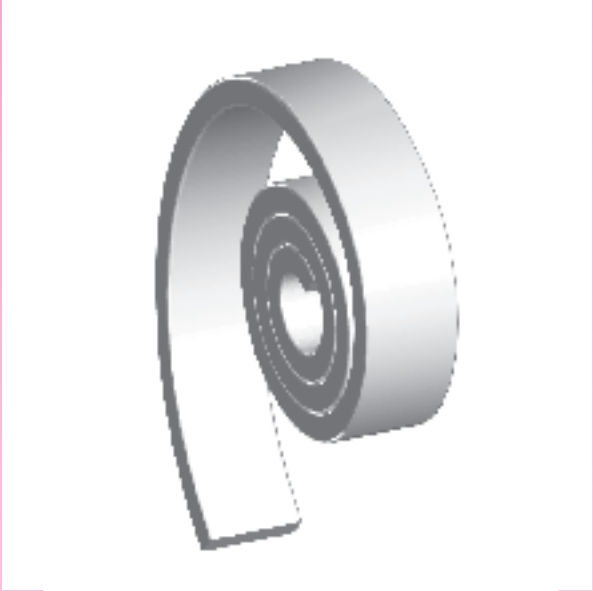

E
DIMENSION
RYT

● Please designate NOK Part number and type & size on your order.

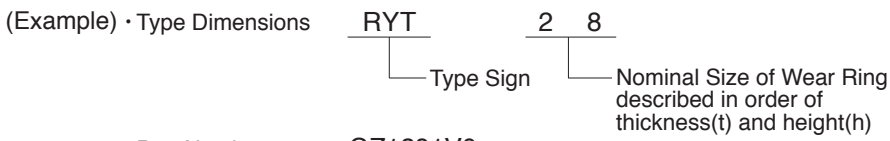

· Part Number GZ1291V0

● Please check the application range on B-10 and B-11 before selecting the type.

| | |
|-----------------|----------|
| Material | NOK 05ZF |
|-----------------|----------|

RYT TYPE WEAR RING

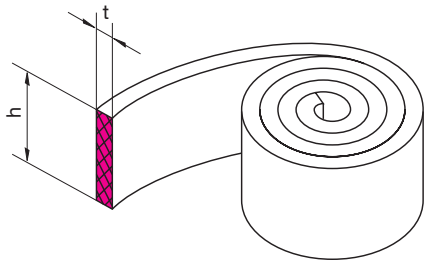

*One roll length is 10 m.

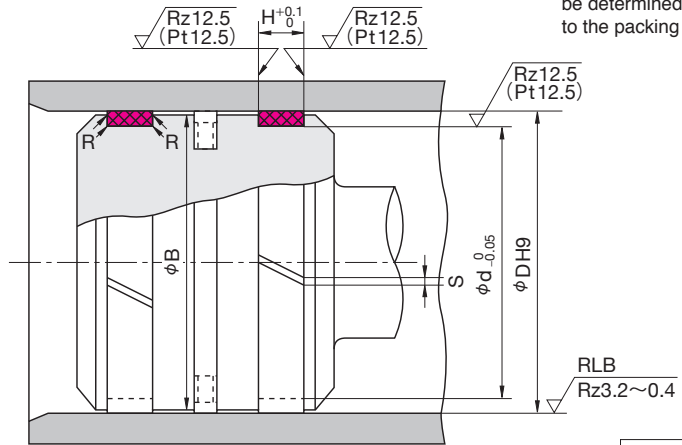

R = 0.3 or below

The inner surface of the cylinder tube should be finished by burnishing(RLB) or honing(GH) to 0.4 to 3.2μmRz (0.1 to 0.8μmRa). Especially under severe lubricating condition, burnishing is required.

- The roughness is JIS B 0601 : 2001. When regulation length cannot be kept, apply Pt.

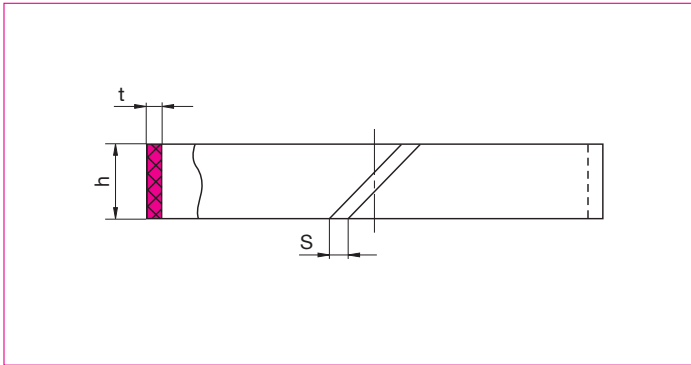

Remark) Determine the length of wear ring = L according to the formula below.

$$L = \pi \cdot (D - t) - S$$

| Nominal Number | Nominal Size of Wear Ring | | | Housing dimensions | | | NOK Part Number |
|----------------|---------------------------|----|---------|--------------------|-----|----|-----------------|
| | t | h | S | φD | φd | H | |
| RYT 8 | 2 | 8 | 1 ~ 1.5 | 18 ~ 63 | D-4 | 8 | GZ1291V0 |
| 10 | | 10 | 1 ~ 2 | 33 ~ 80 | | 10 | GZ1292V0 |
| 15 | | 15 | 1.5 ~ 3 | 41 ~ 130 | | 15 | GZ1293V0 |
| 20 | 2.5 | 20 | 2 ~ 4 | 65 ~ 160 | D-5 | 20 | GZ1294V0 |
| 25 | | 25 | 2 ~ 6 | 85 ~ 225 | | 25 | GZ1295V0 |
| 30 | | 30 | 3 ~ 6.5 | 112 ~ 250 | | 30 | GZ1296V0 |
| 35 | | 35 | 3.5 ~ 8 | 132 ~ 300 | | 35 | GZ1297V0 |
| 40 | | 40 | 4 ~ 9 | 150 ~ 350 | | 40 | GZ1298V0 |
| 45 | | 45 | 4 ~ 10 | 165 ~ 400 | | 45 | GZ1299V0 |
| 50 | 3 | 50 | 5 ~ 11 | 205 ~ 450 | D-6 | 50 | GZ1300V0 |
| 55 | | 55 | 6 ~ 13 | 230 ~ 500 | | 55 | GZ1301V0 |
| 60 | | 60 | 7 ~ 15 | 260 ~ 600 | | 60 | GZ1302V0 |
| 70 | | 70 | 8 ~ 28 | 290 ~ 1000 | | 70 | GZ1303V0 |

* RYT type wear ring of other dimensions than the above can be available on demand, please consult NOK.